

7 WRAPTHERM INSTALLATION

1. Snap chalkline for guidance.
2. Measure and pre-cut material as necessary.
3. Starting at a corner, peel back release paper by approx. 150mm. (Fig.7)

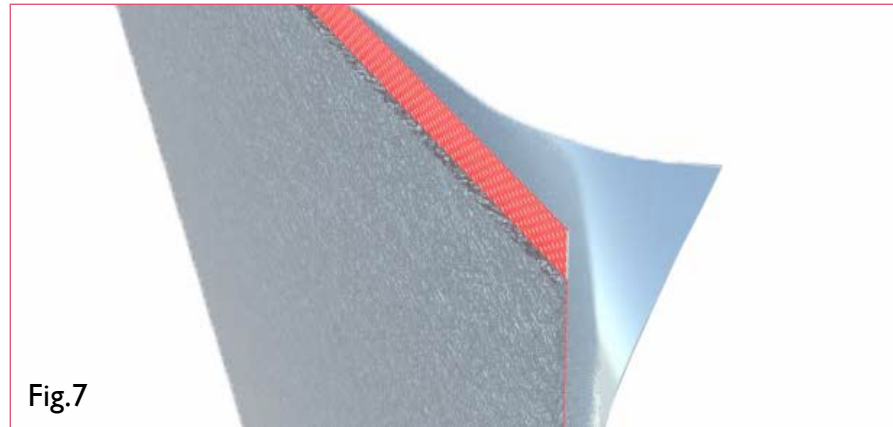

Fig.7

4. With the release paper folded back, lightly apply the exposed adhesive backing to the substrate.
5. Starting from the middle, apply light pressure to the adhered edge to smooth out any air bubbles, releasing trapped air from either side.
6. Check sheet for proper alignment. Reposition as required.
7. Use a hand roller across the entire adhered section. (Fig.8)

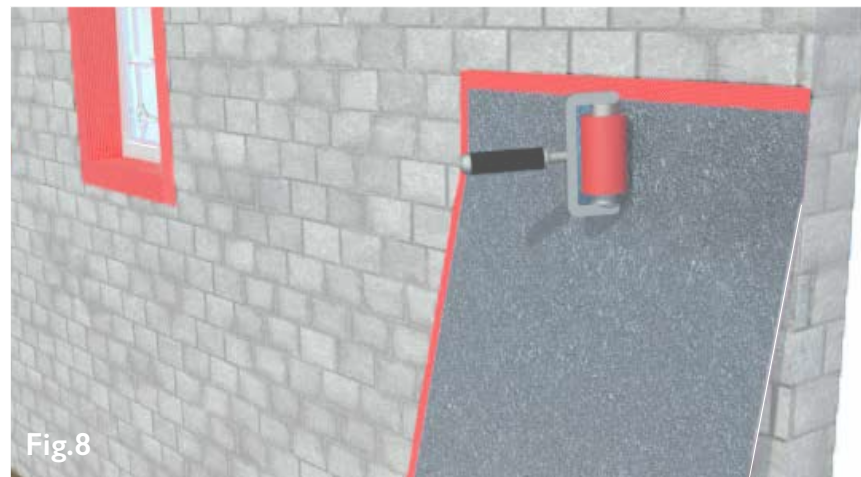

Fig.8

8. Remove the remaining release paper and adhere Wraptherm back to the substrate using a hand roller &/or firm hand pressure. Do this gradually as not to trap air bubbles behind the material and carefully to prevent the transfer of aerogel dust to the adhesive backing as much as possible.
9. Repeat steps 1-8 and install the remaining Wraptherm sheets. Ensure that the Spacetherm edges of every new sheet overlap the Wraptite edges of the previous sheet. (Fig.3) Butt all edges together tightly to ensure thermal continuity.

8 WINDOW & DOOR REVEALS

1. Using a utility knife, cut Wraptherm sheets to fit around window and door penetrations. Cut the Wraptherm edge so it is flush with the opening. (Fig.9)
2. Cut strips of Wraptherm slightly wider than the depth of the window/door reveal so that the outside edge of the strip extends beyond the threshold and flush with the front of the sheet. (Fig.10)

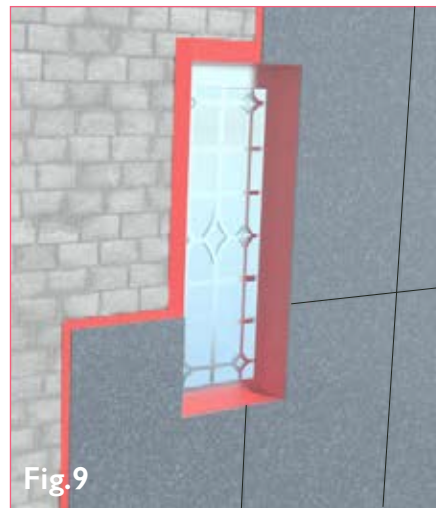

Fig.9

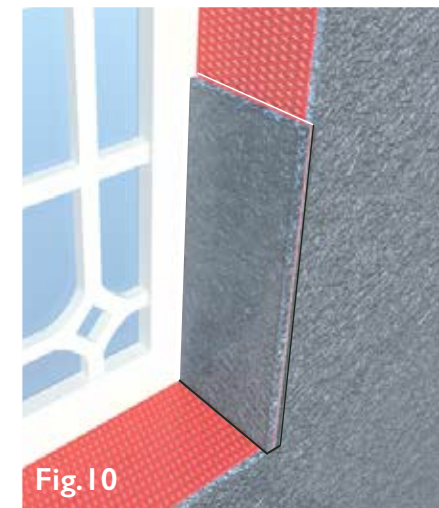

Fig.10

3. Continue cutting and installing Wraptherm strips within the reveal in the same manner, ensuring sufficient insulation overlap and abutting adjacent strips tightly together to ensure thermal continuity. (Fig.11)
4. Alternatively, Spacetherm WRB can replace Wraptherm within window and door reveals. (see: *Spacetherm® WRB Installation Guide*)

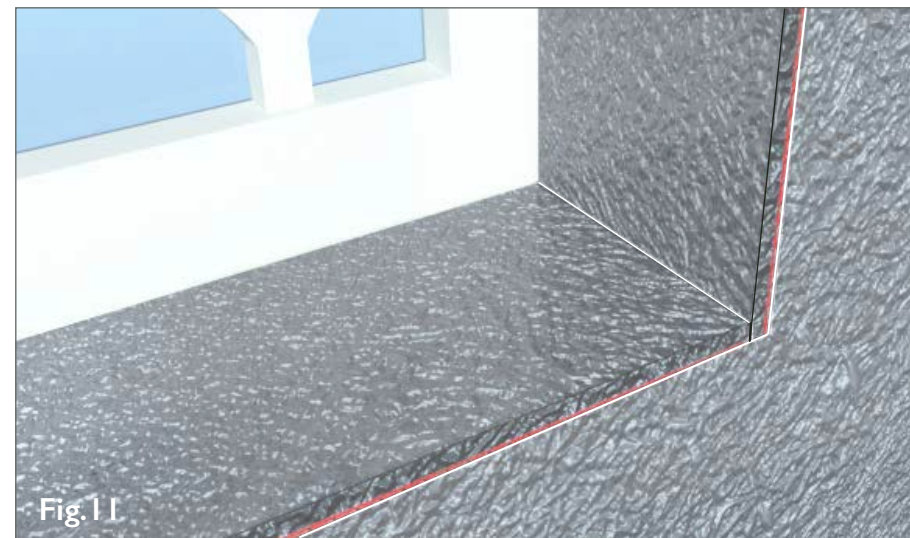

Fig.11

Contact our Technical Department

The A. Proctor Group has a dedicated Technical Department which can assist with installation details, view drawings for approval and give specialist advice on the correct use of the A. Proctor Group products.

For Technical Advice on installation details and product applications contact the A. Proctor Techline:

Telephone
01250 872261
Facsimile
01250 872727

Email
technical@proctorgroup.com

For more information contact us:
+44 (0) 1250 872261
www.proctorgroup.com



Wraptherm®

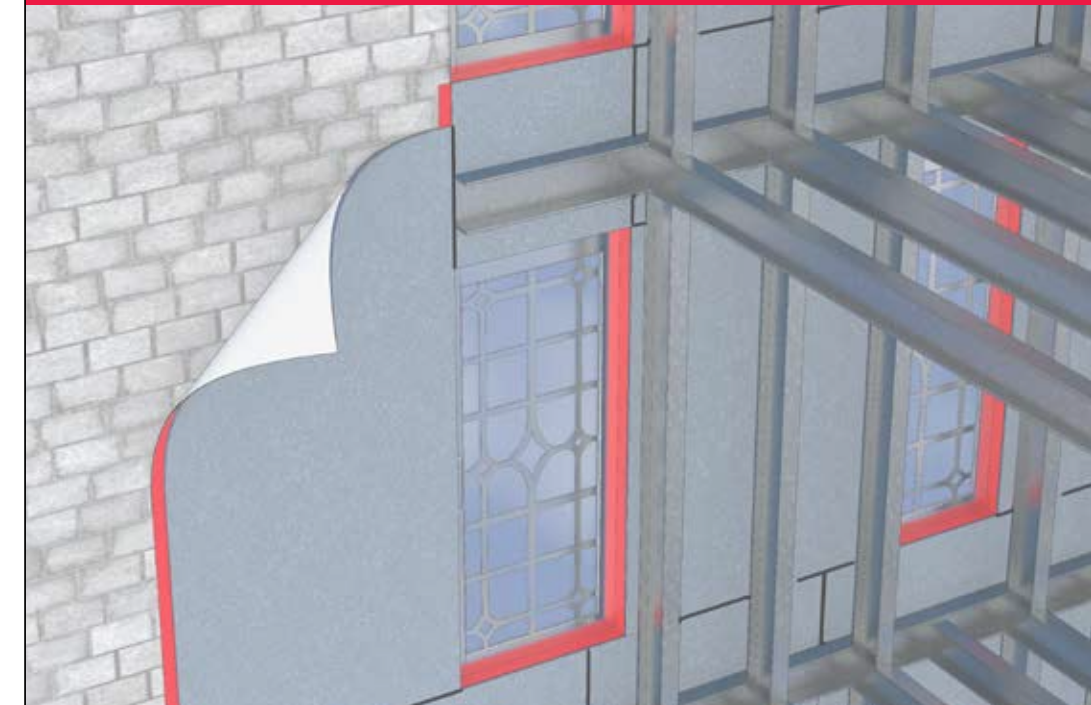

INSTALLATION GUIDE



1 PRODUCT: OVERVIEW

Wraptherm is a composite material comprising 10mm Spacetherm® insulation blanket bonded to the face of Wraptite® vapour permeable, airtight, self-adhesive membrane (Fig.1). The use of Wraptherm provides improved airtightness levels while also reducing the effect of thermal bridging.

Wraptherm was developed for the refurbishment of existing buildings where there is a requirement to enhance both the thermal and airtightness performance of the building. Wraptherm can be applied to the internal face of an existing façade. It provides a vapour neutral yet airtight layer that is fully adhered to the substrate layer with the added benefit of a 10mm thick layer of Spacetherm insulation. Over this airtight/thermal composite, framing can be installed with less worry about cold bridging as the risk is reduced thanks to the Spacetherm layer. Additional thermal insulation can be included within the frame to meet the U-values required for the refurbishment.

The offset nature of the Spacetherm insulation bonded over the Wraptite backing means joints between Wraptherm sheets are simply sealed, ensuring the continuity, integrity and robustness of the airtight layer.

Coverage

Nominal Thickness

Weight

1200x1200mm or 2400x1200mm

11.5mm

1.2kg or 2.4kg per sheet

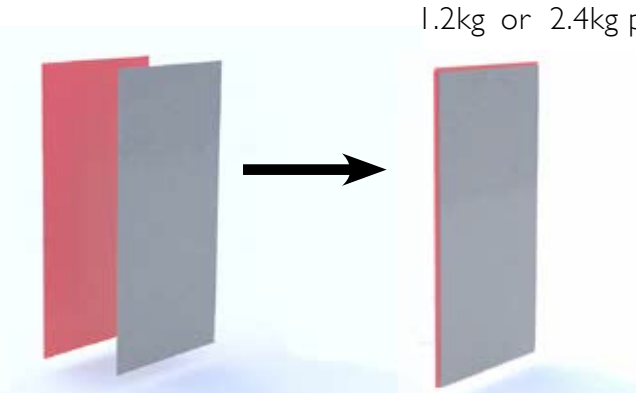

Fig.1

2 RECOMMENDED EQUIPMENT

- | | | |
|-------------------|------------------|-----------------------|
| • Utility Knife | • Marker Pen | • Gloves |
| • Rubber Roller | • Measuring Tape | • Goggles |
| • Chalk Line Tool | • Dust mask | • Clean cloth / Brush |

3 SUBSTRATE PREPARATION

- Substrate condition is critical to the adhesive performance of any self-adhered membrane composite including Wraptherm.
- Surfaces must be clean, dry and free from all bond-breaking contaminants, sharp protrusions or other matter that may hinder adhesion to the substrate. Clean any loose dust or dirt from the substrate by wiping with a clean dry cloth or brush. Remove and replace any damaged structural wall components.

4 INSTALLATION: OVERVIEW

- Wraptherm can be installed over various substrates including:
 - > Aluminium (Painted or Mill Finish)
 - > Anodised Aluminium
 - > Concrete Block
 - > Exterior Grade Gypsum/Fibre Board
 - > Galvanised Metal
 - > In-Situ Concrete
 - > OSB
 - > Precast Concrete
 - > Pre-Painted Steel
 - > Rigid Vinyl
 - > Steel
 - > Plywood
- Building design requirements should be considered prior to application of Wraptherm to minimise waste. Penetrations/openings will need to be correctly detailed to ensure a continuous thermal and airtight installation.
- Wraptherm can be installed in either a vertical or horizontal orientation. Use a hand roller or firm overall hand pressure to ensure a continuous and effective bond to the substrate.
- IMPORTANT: Failure to apply sufficient pressure, either by hand or by roller, may result in poor adhesion to the substrate which may result in subsequent reduction in airtightness levels.
- Each Wraptherm sheet has two Spacetherm edges and two 50mm Wraptite lap edges. (Fig.2) Always install Wraptherm in a way that ensures the Spacetherm edges overlap the Wraptite laps of adjacent sheets. (Fig.3) Butt Wraptherm sheets tightly together to ensure thermal continuity.
- Wraptherm should only be applied on dry surfaces and when air and surface temperatures are above 0°C. Do not install Wraptherm on damp, dusty or loose surfaces.
- It is important to review each application and be aware there may be situations that require modifications to the typical installation instructions to accommodate unique project requirements. Contact the A. Proctor Group Technical Department for assistance as required.

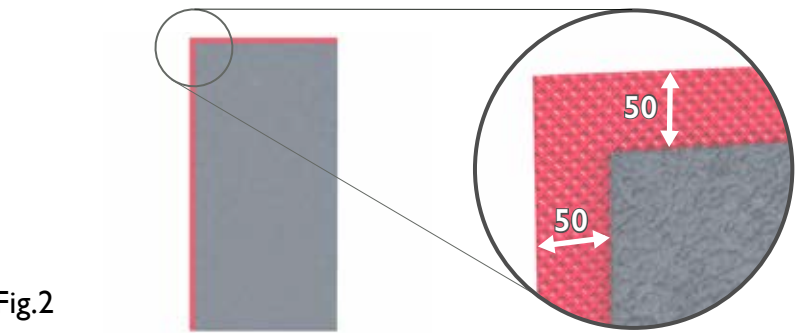

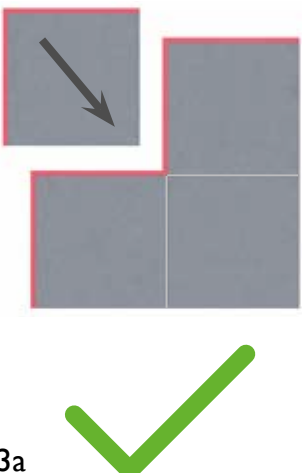

Fig.3a

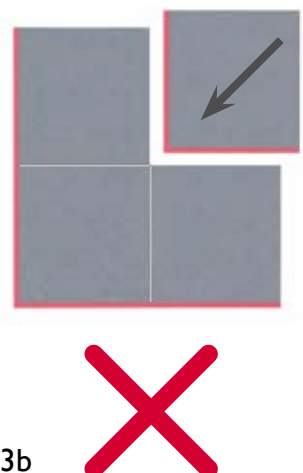

Fig.3b

5 WALL PENETRATIONS & DEFECTS

1. Pre-fill any joints, gaps and cracks resulting from penetrations through the wall or existing wall defects with Wraptite Liquid Flashing &/or Wraptite Tape according to published guidelines. (refer to: *Wraptite®: Membrane & Accessories Installation Guide*)

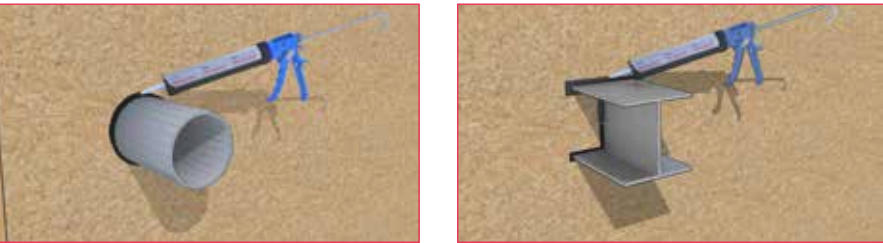
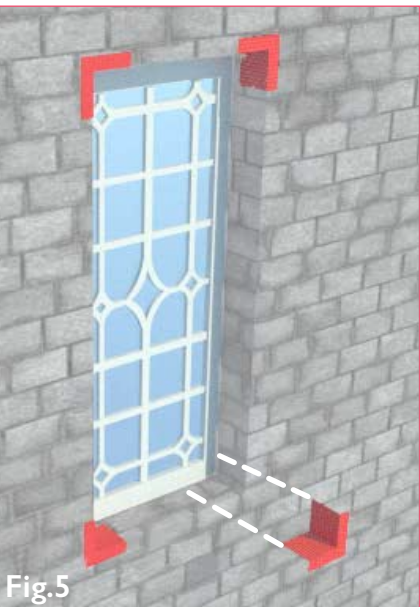

Fig 4: Sealing gaps and cracks with Wraptite Liquid Flashing. Refer to *Wraptite®: Membrane & Accessories Installation Guide* for full details.

6 WINDOWS & DOORS

1. Before installing Wraptherm, seal all window and door penetrations with Wraptite Corners, Wraptite Tape and Wraptite Liquid Flashing according to published guidelines (Fig 5): refer to: *Wraptite®: Membrane & Accessories Installation Guide*.



OPTION 1: If Wraptherm is to be used within window reveals, Wraptite Tape may be used along the reveal edges only (Fig.6a).

OPTION 2: If Spacetherm WRB is to be used within the window reveals, Wraptite Tape should extend the full depth of the reveal opening (Fig.6b)

