

Spacetherm[®] A2 Product Range



DESCRIPTION

Spacetherm SLENTEX[®] A2 is a flexible, high-performance, silica aerogel-based insulation material of limited combustibility used for exterior and interior applications. Supplied in a variety of finishes, the substantial layers of Spacetherm SLENTEX[®] A2 meet the requirements for A2 classification. The product is used to optimise the thermal performance and fire properties of façade systems in a number of ways. These include enhancing the thermal performance of the ventilated façade, and addressing thermal bridging in the façade. Spacetherm SLENTEX[®] A2 is also useful in minimising thermal bridges around windows in areas such as window reveals and roller shutter cases.

With a thermal conductivity of 0.019 W/mK, Spacetherm SLENTEX[®] A2's performance, coupled with its superior Reaction to Fire classification, qualify it as one of the best insulation materials available worldwide. Engineered for space-critical applications, the product offers low thermal conductivity, superior compression strength, plus breathability allied to hydrophobic characteristics. Its flexibility and ease of use has proven it as the insulation material of choice in many applications and for a wide variety of clients.



Spacetherm A2

KEY FEATURES

- Class leading A2 reaction to fire classification from an Aerogel insulation
- Superior thermal performance
- Limited combustibility
- Water vapour diffusion open
- Permeable
- Flexible
- Thinnest Aerogel insulation available

SPACETHERM SLENTEX[®] A2 TECHNICAL DATA

Reaction-to-Fire	EN 13501-1:2010	A2-s1, d0
Thickness	-	10, 20, 30, 40mm*
Width	-	up to 1500 mm
Colour	-	White
Thermal Conductivity	EN 12667	0.019 W/m-K
Density	EN 1602	190-200 kg/m ³
Dimensional Stability	EN 1604	$\Delta < 0.6\%$ @ 70°C, 48hrs
Compressive Strength	EN 826	30 kPa at 10% compression
Tensile Strength	EN 1607	16 kPa perpendicular to faces
Tensile Strength	EN 1608	1085 kPa parallel to faces
Short Term Water Absorption	EN 1609 (A)	0.04 kg/m ² (partial immersion 24hrs)
Long Term Water Absorption	EN 12087 (1A)	0.10 kg/m ² (full immersion 48hrs)
Water Vapour Permeability, μ -Value	EN 12086	5
Organic Content of Spacetherm A2	DIN EN 13820	3.8 Gew.-%

ETA - 18/001 | Dated 6th December 2018

*other thicknesses available on request

SPACETHERM SLENTEX® A2

Spacetherm SLENTEX® A2 consists of unfaced sheets of high performance aerogel composite insulation. The possible applications of Spacetherm SLENTEX® A2 are virtually limitless. Spacetherm SLENTEX® A2 can be fixed directly to floors and walls in 10mm increments, which maximises space and adds to ultimate thermal performance.

SPACETHERM A2 MULTI

Spacetherm A2 Multi is a high-performance laminate specifically designed to be laid directly onto both existing floors & walls. Spacetherm A2 Multi consists of Spacetherm SLENTEX® A2 insulation blanket bonded to a 6mm Magnesium Oxide Board. The overall minimum thickness of Spacetherm A2 Multi is only 16mm.

SPACETHERM A2 DIRECTFIX

Spacetherm A2 Directfix is a high performance laminate which is specifically designed to be fixed directly to the wall. It consists of Spacetherm SLENTEX® A2 insulation blanket bonded to 12.5mm plasterboard (with or without a VCL), with an additional pre-bonded plywood reinforcement to the plasterboard. This reinforced laminate will reduce the risk of shot-fired nails failing to create a robust fix and will also reduce the risk of drill bit snagging, should you be using a traditional mechanical fixing method. Spacetherm A2 Directfix is available in a minimum thickness of 28.5mm.

SPACETHERM A2 WALLBOARD

Spacetherm A2 Wallboard is a high performance laminate which is specifically designed to be fixed to timber straps or steel studs which allows for services. It consists of Spacetherm SLENTEX® A2 insulation blanket bonded to 12.5mm plasterboard (with or without a VCL), and is ideal for use in applications where low U-values are required but space is at a premium and a service void is required. Spacetherm A2 Wallboard is available in a minimum thickness of 22.5mm.

SPACETHERM A2 COLD BRIDGE STRIP

Spacetherm A2 Cold Bridge Strip (CBS) is designed to prevent cold bridging through a component or element of a structure. Spacetherm A2 CBS consists of Spacetherm SLENTEX® A2 insulation which may be encapsulated in various materials. Spacetherm A2 CBS is an ideal choice for timber or steel frame structures and on request, can be cut to a variety of widths to suit different applications. In addition to timber and steel structures, it can also be used in other applications where cold bridging presents a challenge.

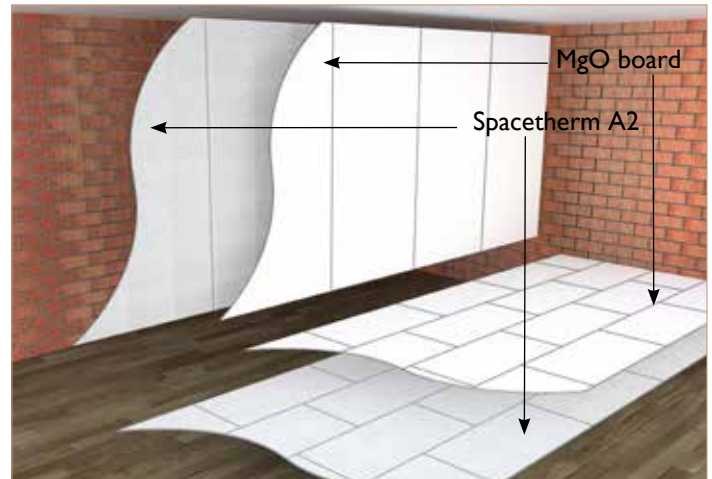

Spacetherm A2 Multi

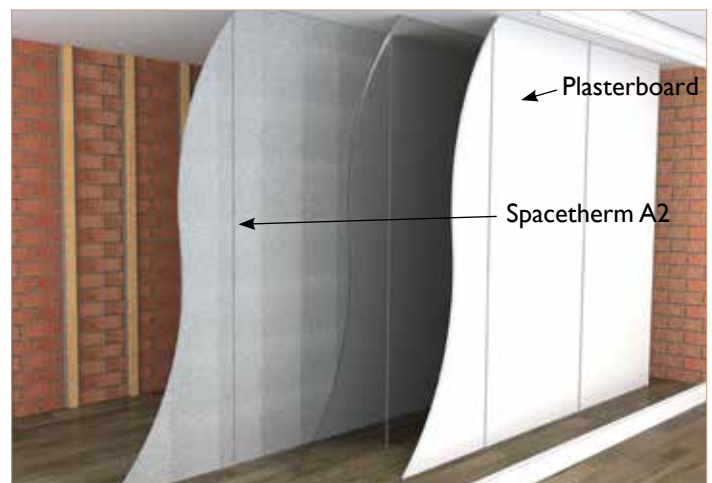

Spacetherm A2 Wallboard

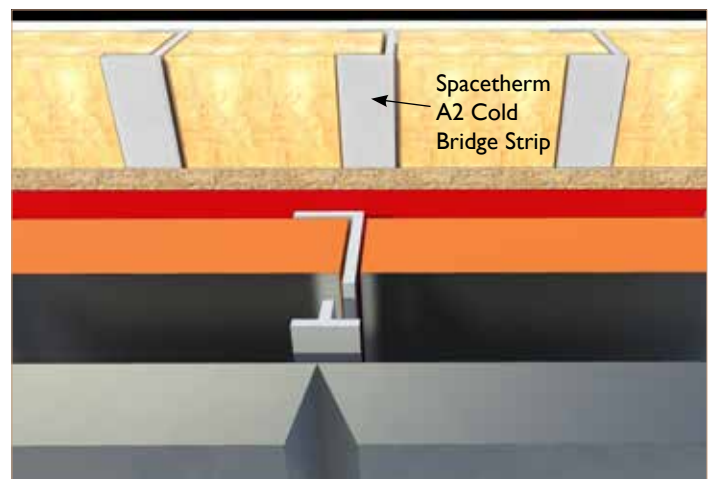

Spacetherm A2 Cold Bridge Strip



Download a Spacetherm brochure from our website...

www.proctorgroup.com



contact@proctorgroup.com | +44 (0) 1250 872261

Revised February 2021